

# HOBART

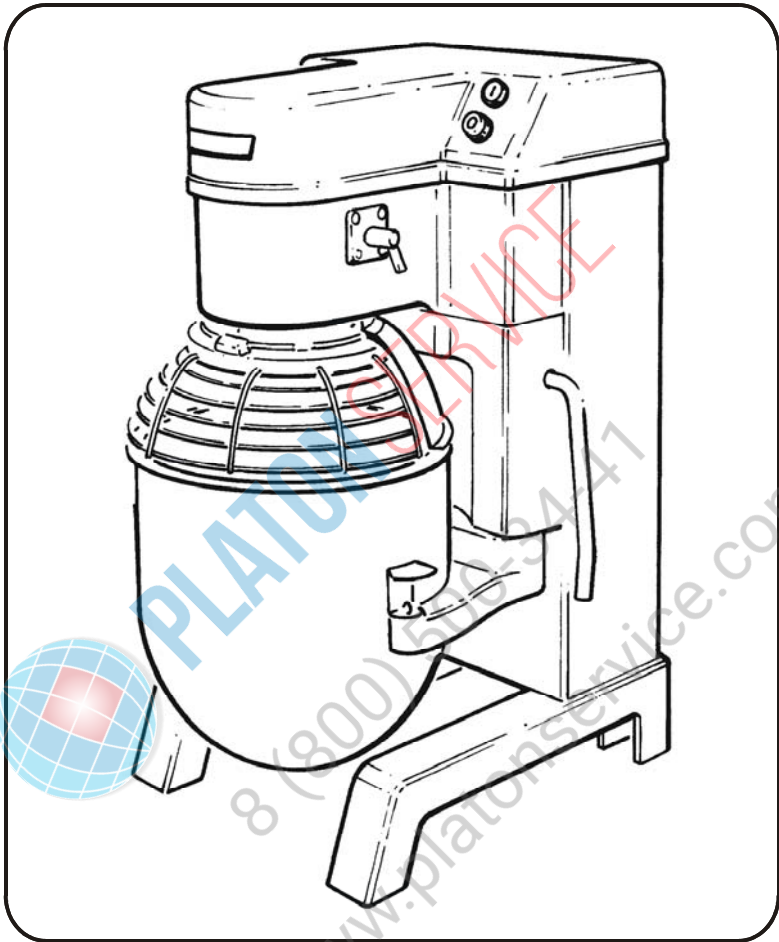

## HSM 20 & NCM 20

Catalogue of Replacement Parts  
Catalogue de Pieces de Rechange  
Ersatzteilkatalog



PLE 200321-G-12-08  
EU 8240

Page Seite	
2	Base and Pedestal Unit Base et Colonne Gehäuse mitt standfüßen Base y pedestal
3	Bowl Lift Revelage de bol Kesselheber Palanca para subir el tazón
4	Shifter Unit Changement de vitesses Geschwindig Keitswahlschalter Cambio de velocidades
5	Centre Shaft Arbre Central Getriebewelle Eje central
6	Transmission Shaft Arbre Intermédiare Antrießswelle Eje de transmisión
7	Worm Gear Shaft Arbre roue hélicoidal Schneckenradwelle Eje de engranaje sinfín
8	Planetary Planétaire Planetengesriebe Planetario
9/10/11/12	Guard Assembly Sécurité de bol Schtutzgitter Mecanismo de la rejilla de protección
13/14	Guard Interlock Assembly Verrouillage de sécurité de bol Sicherheitsschalter Mecanismo interbloqueo de la rejilla de protección
14	Electrics Électriques Elektrik Sistema eléctrico
15	Bowl and Equipment Bol et Équipement Kessel und Austrüstung Tazón y equipo

**Base and Pedestal Unit**  
**Base et Colonne**  
**Gehäuse mitt standfüßen**  
**Base y pedestal**

**HSM 20**  
**NCM 20**

143133-9	STANDARD ESTÁNDAR	HSM 20
143133	STANDARD ESTÁNDAR	NCM 20
143134	TIMER OPTION OPCIÓN DE TEMPORIZADOR	NCM 20
143134-9	TIMER OPTION	HSM 20

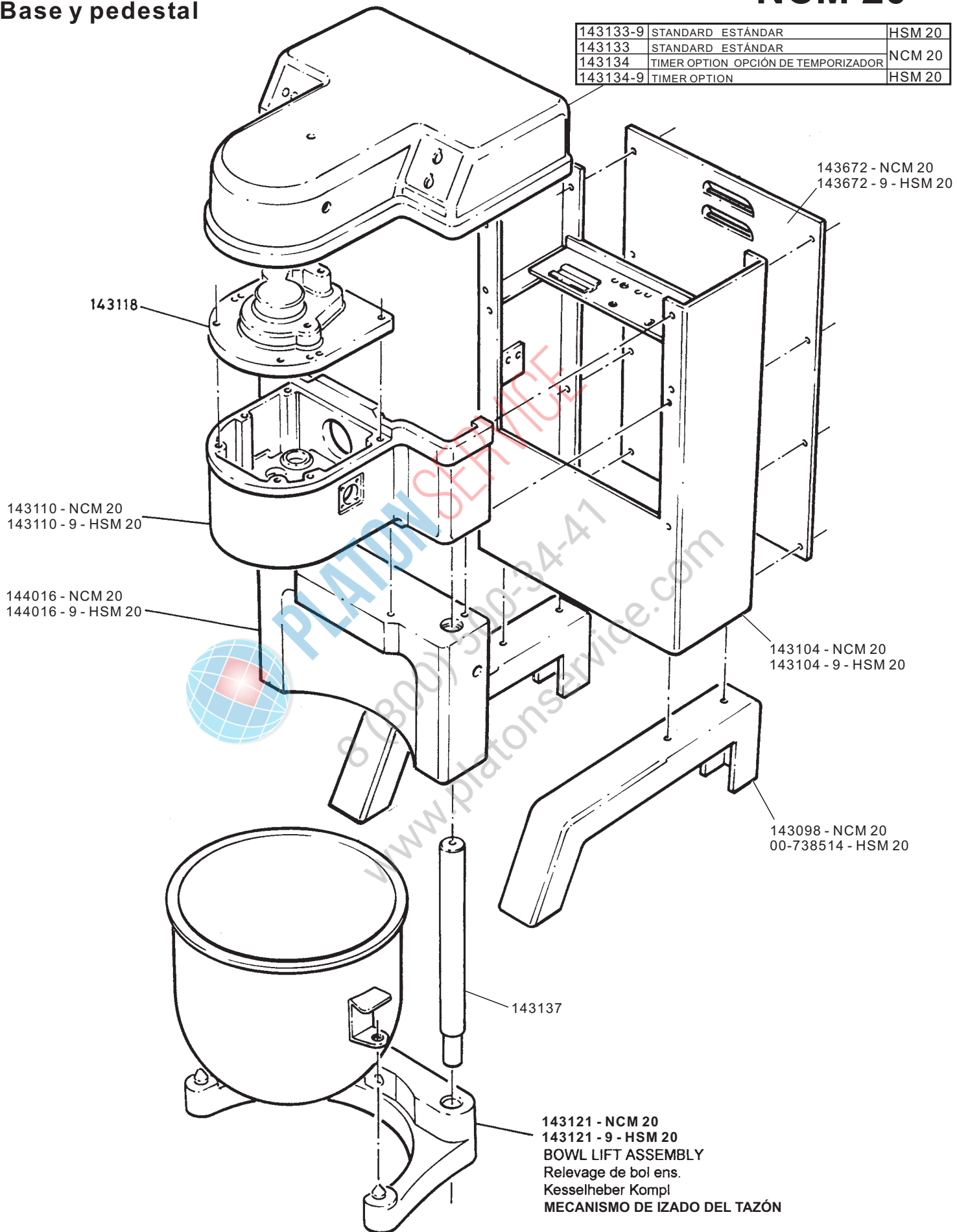

## Bowl Lift Revelage de bol Kesselheber Palanca para subir el tazón

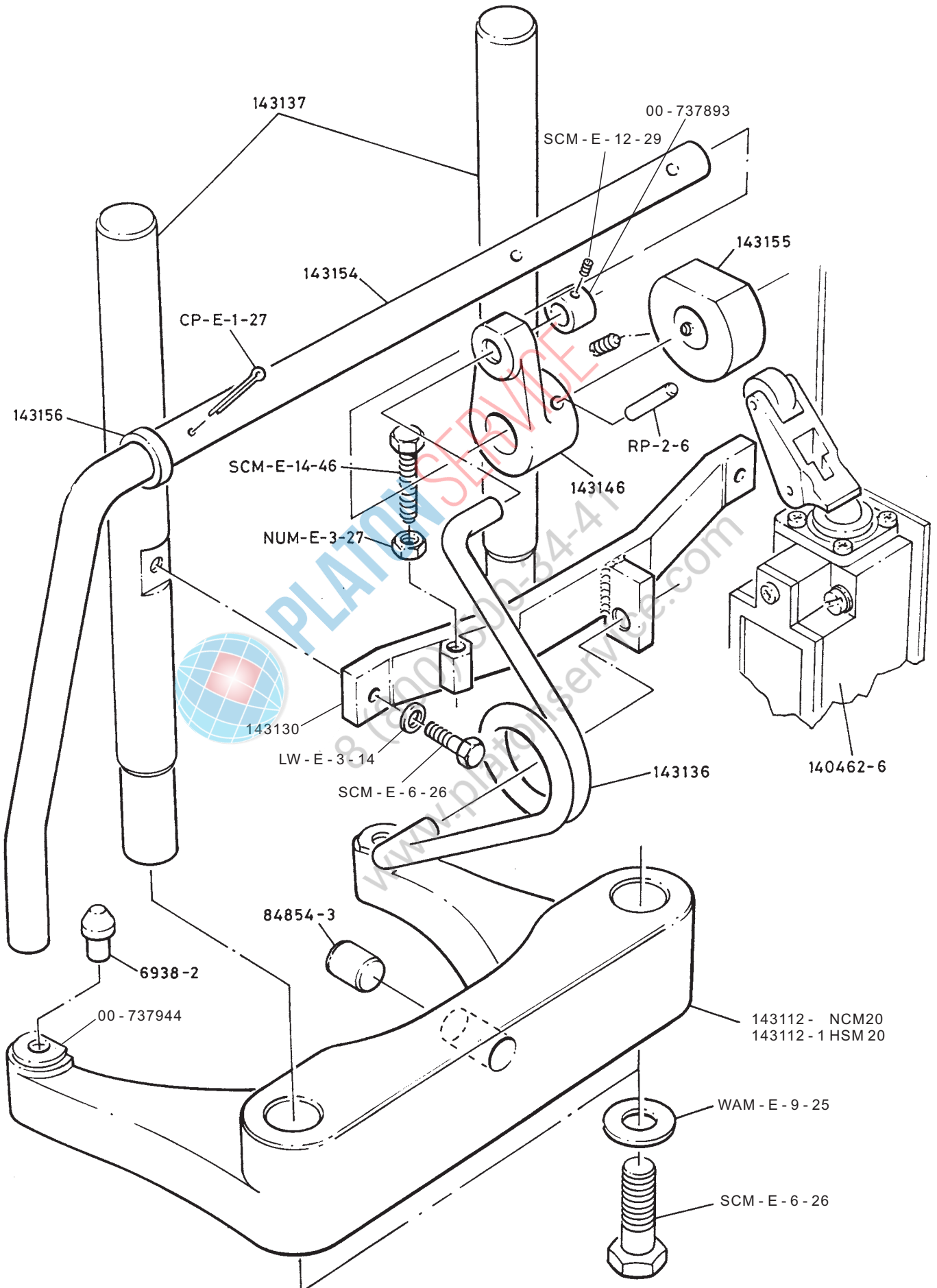

Shifter Unit  
Changement de vitesses  
Geschwindigkeitswahlschalter  
Cambio de velocidades

HSM 20  
NCM 20

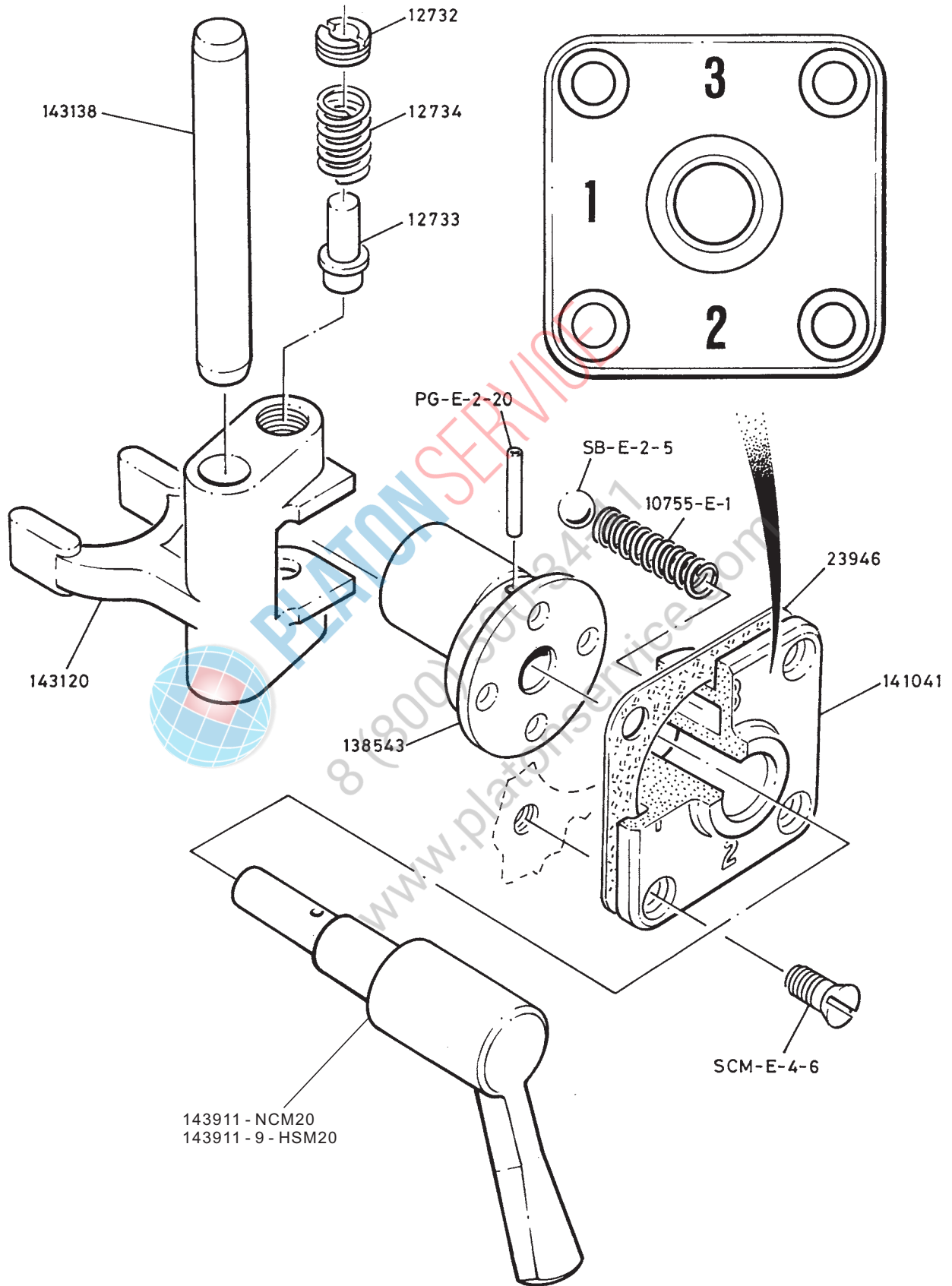



**Centre Shaft  
Arbre Central  
Getriebewelle  
Eje central**

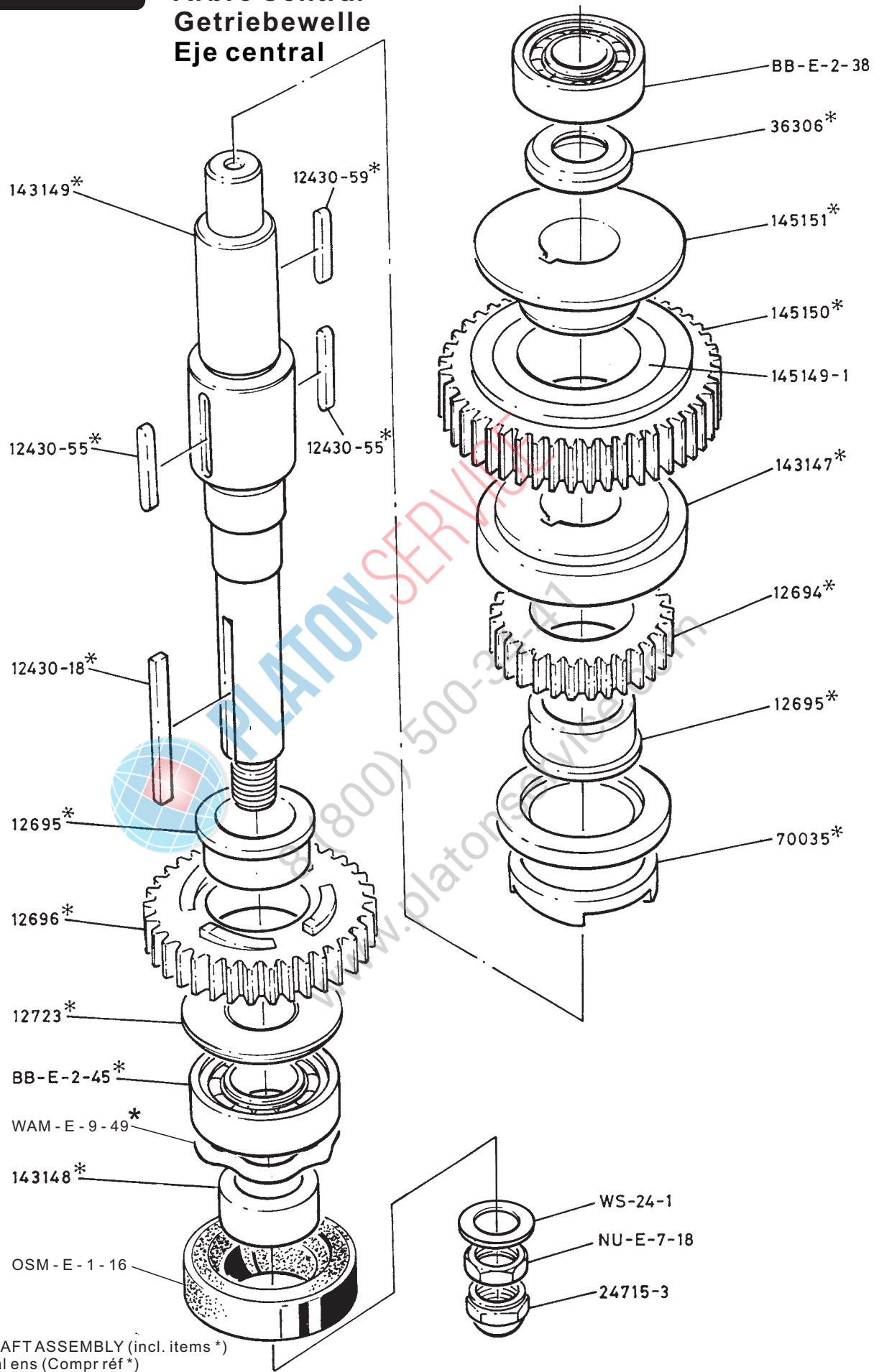

**143153**  
CENTRE SHAFT ASSEMBLY (incl. items \*)  
Arbre Central ens (Compr réf \*)  
Getriebewelle Kompl (inkl. Teile \*)  
CONJUNTO DEL EJE CENTRAL (incl. piezas\*)

**Transmission Shaft  
Arbre Intermédiaire  
Antriebswelle**

**HSM 20  
NCM 20**

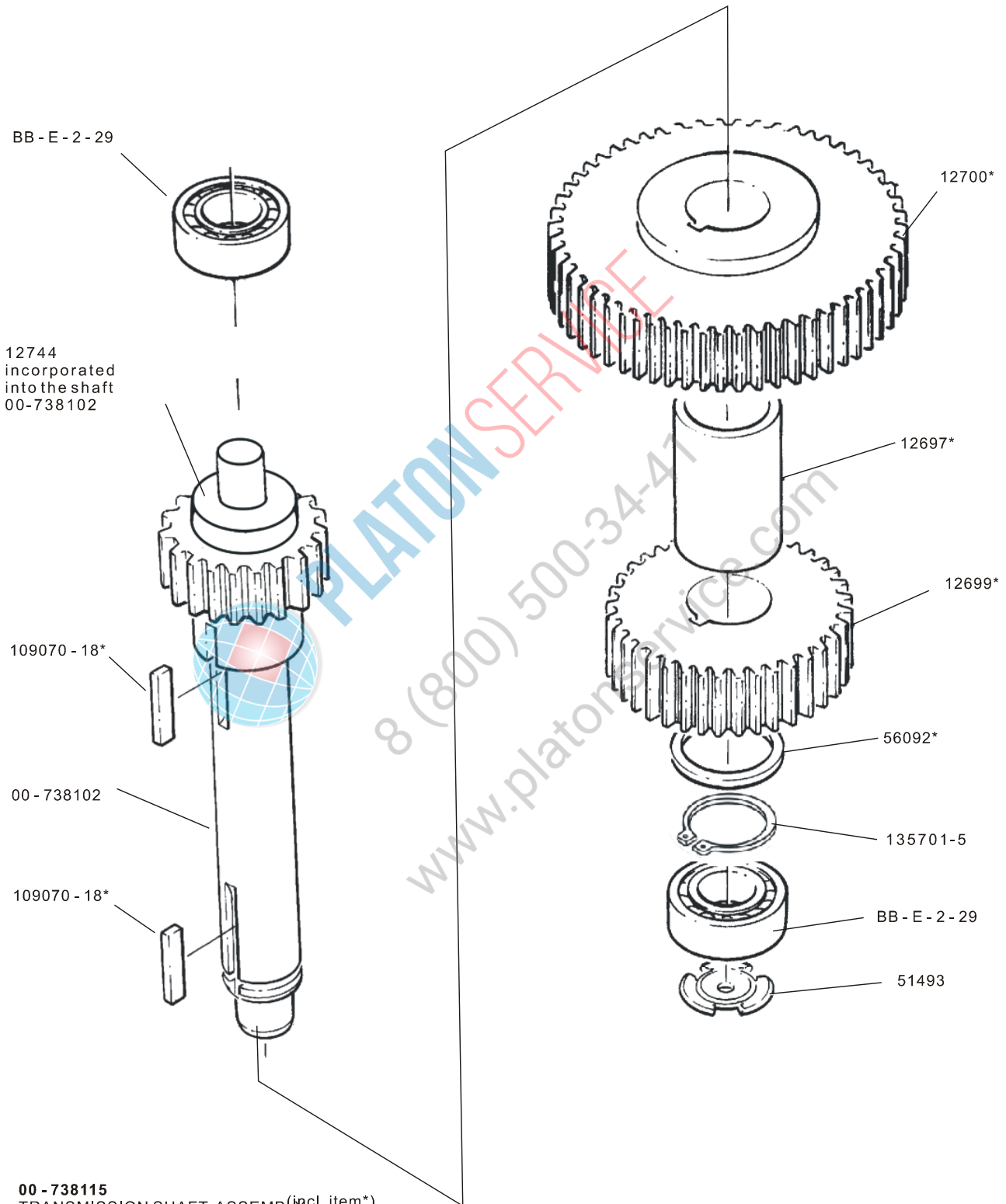

**00 - 738115**  
TRANSMISSION SHAFT, ASSEMBLY (incl. item\*)  
arbre intermediaire, ensemble (compr. ref.\*)  
Antriebwelle, komplett (inkl. Teile\*)







Planetary  
Planétaire  
Planetengesriebe  
Planetario

HSM 20  
NCM 20

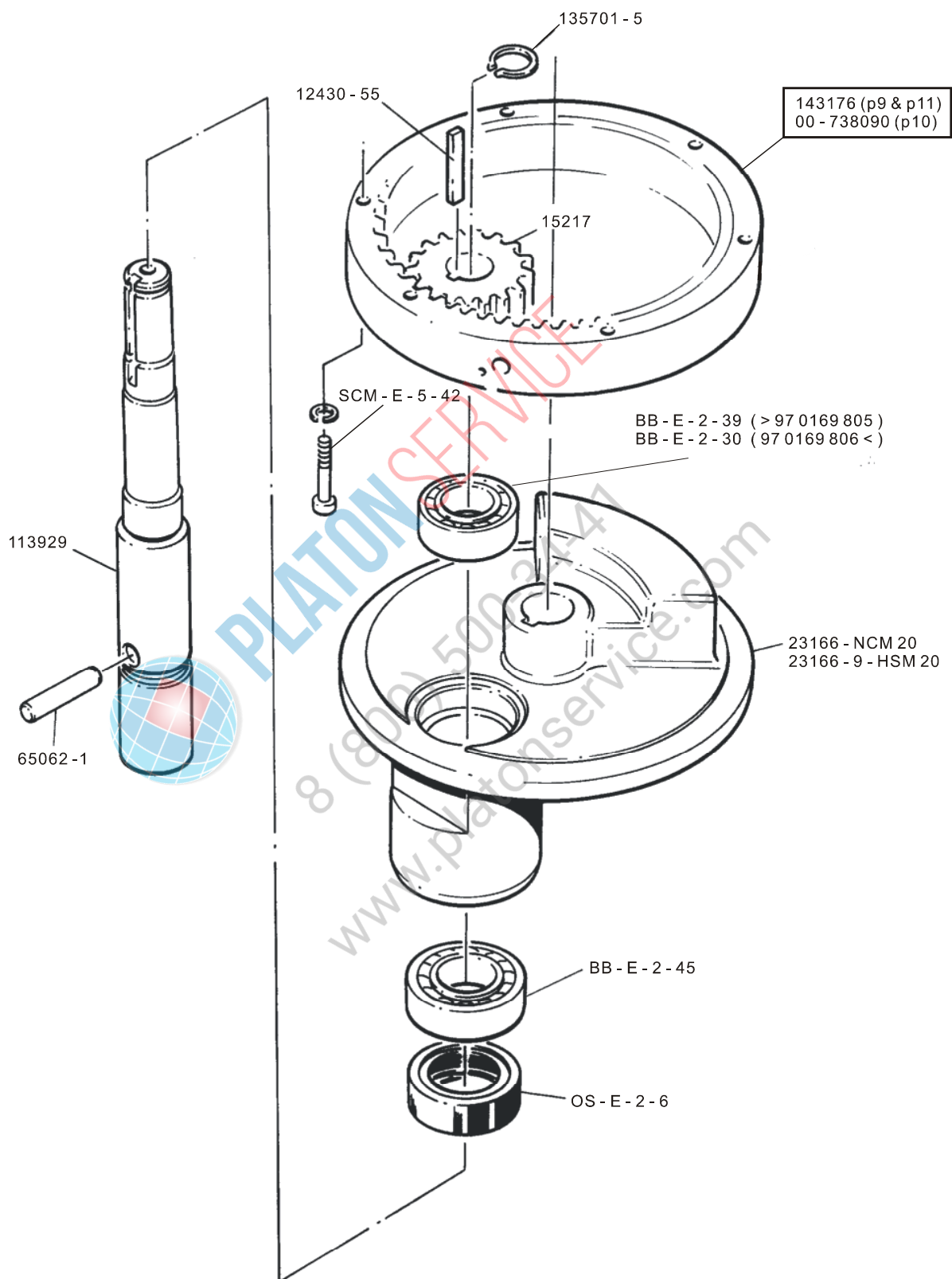



Guard Assembly  
Sécurité de bol  
Schutzgitter  
Mecanismo de la rejilla de protección

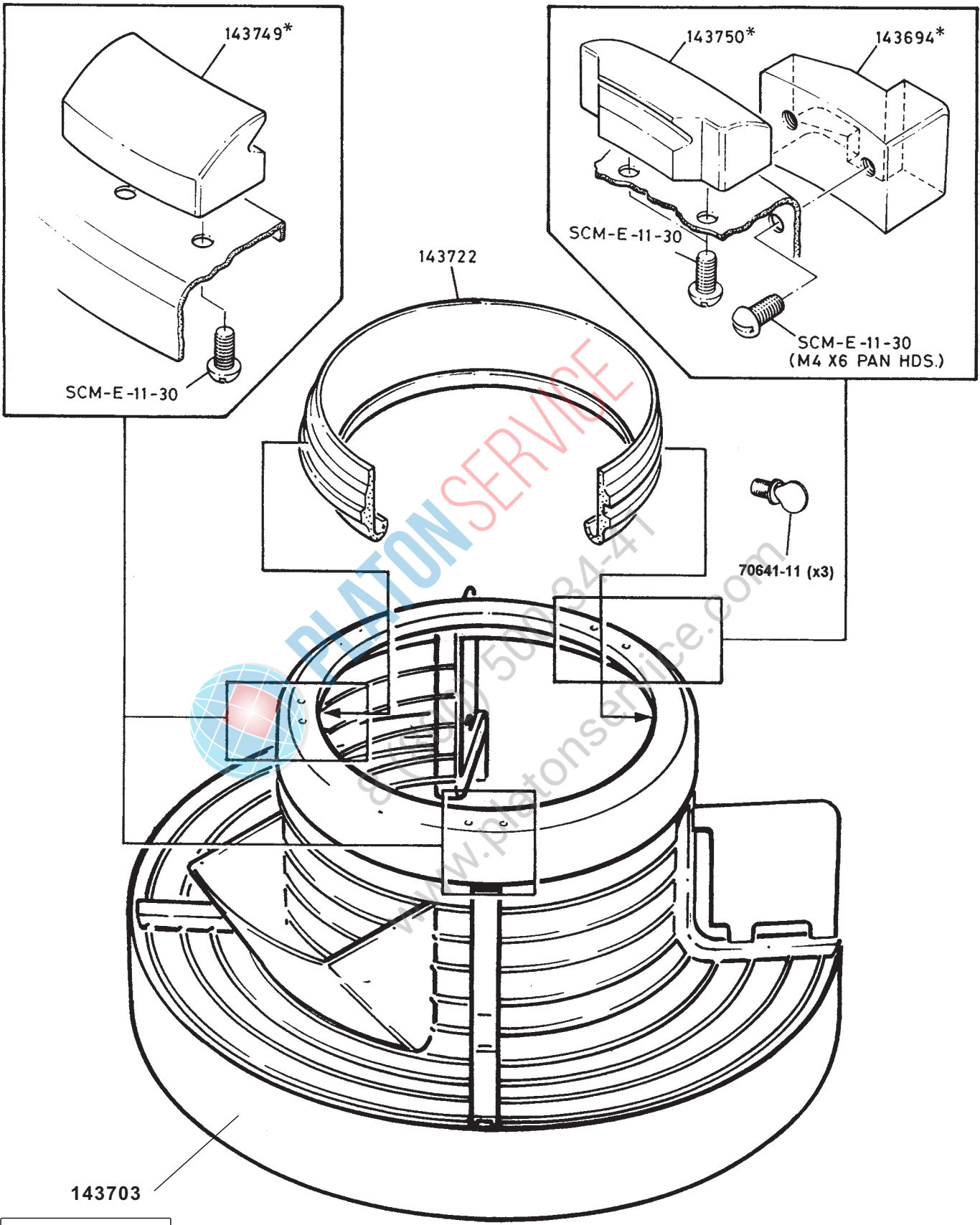

Incl. Items \*  
Com. Léf  
Inkl. Teile  
INCL. PIEZAS\*

Guard Assembly  
Sécurité de bol  
Schutzgitter  
Mecanismo de la rejilla de protección

HSM 20  
NCM 20

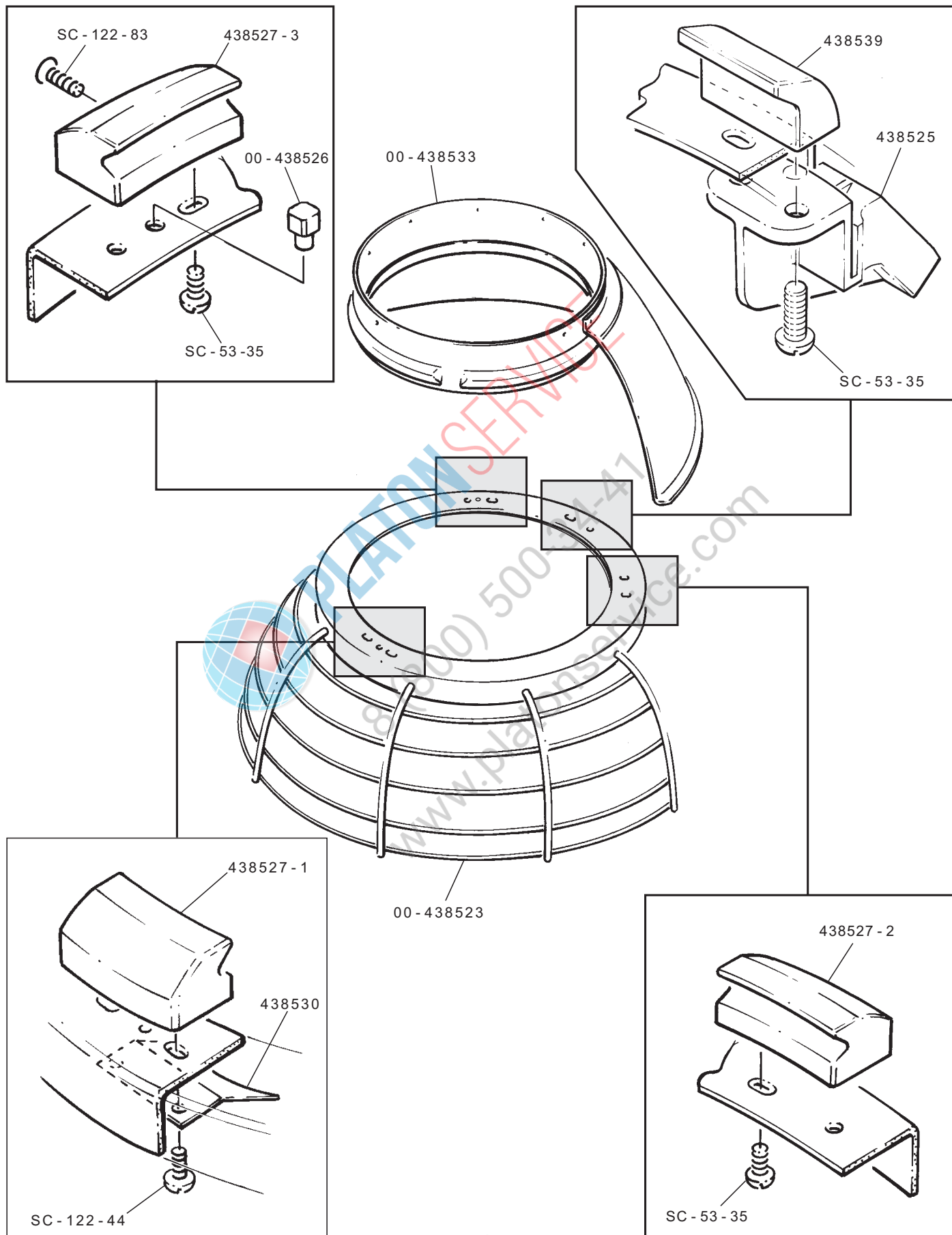



**Guard Assembly (GERMAN)**  
**Sécurité de bol**  
**Schutzgitter**  
**Mecanismo de la rejilla de protección**

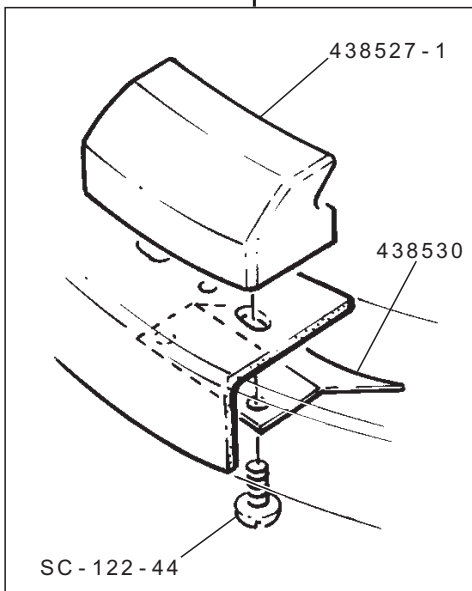
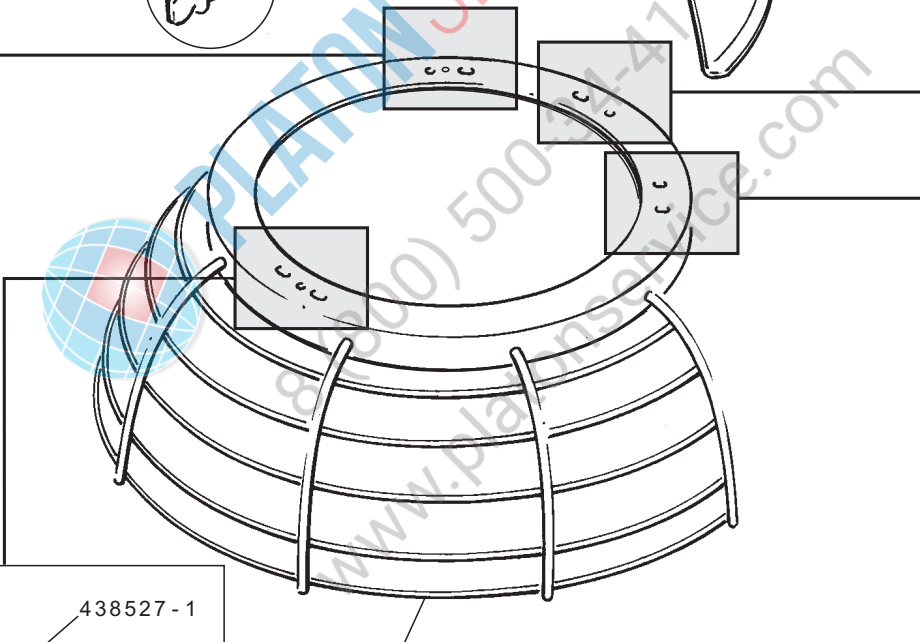
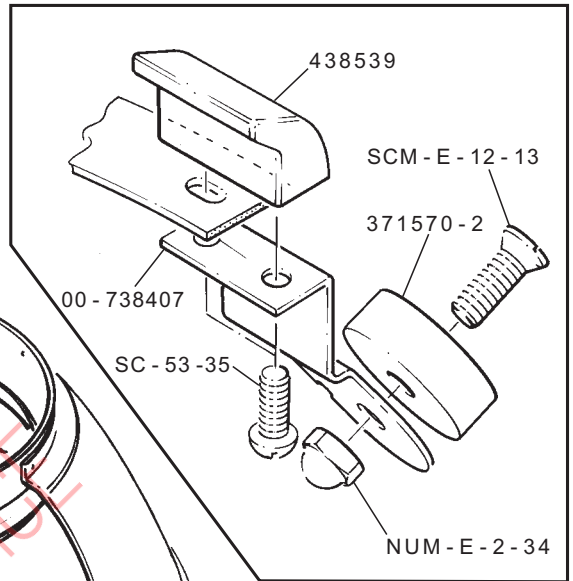
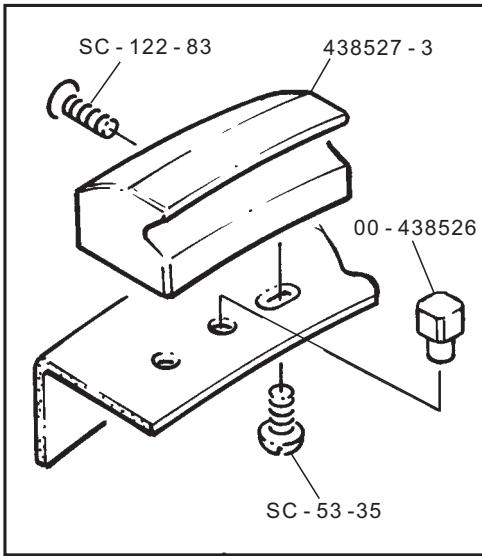

00 - 738451 Guard Assembly  
Sécurité de bol  
Schutzgitter  
Mecanismo de la rejilla de protección

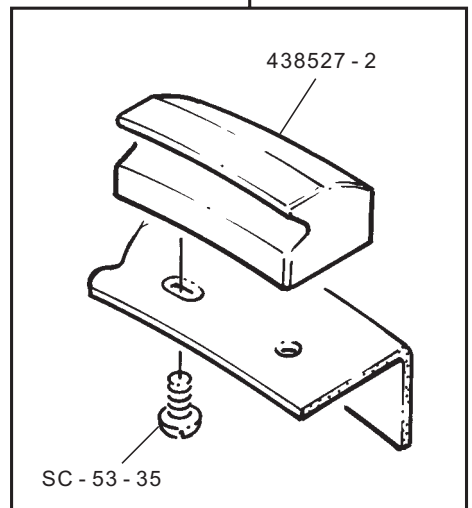

Guard Assembly  
Sécurité de bol  
Schutzgitter  
Mecanismo de la rejilla de protección

HSM 20  
NCM 20

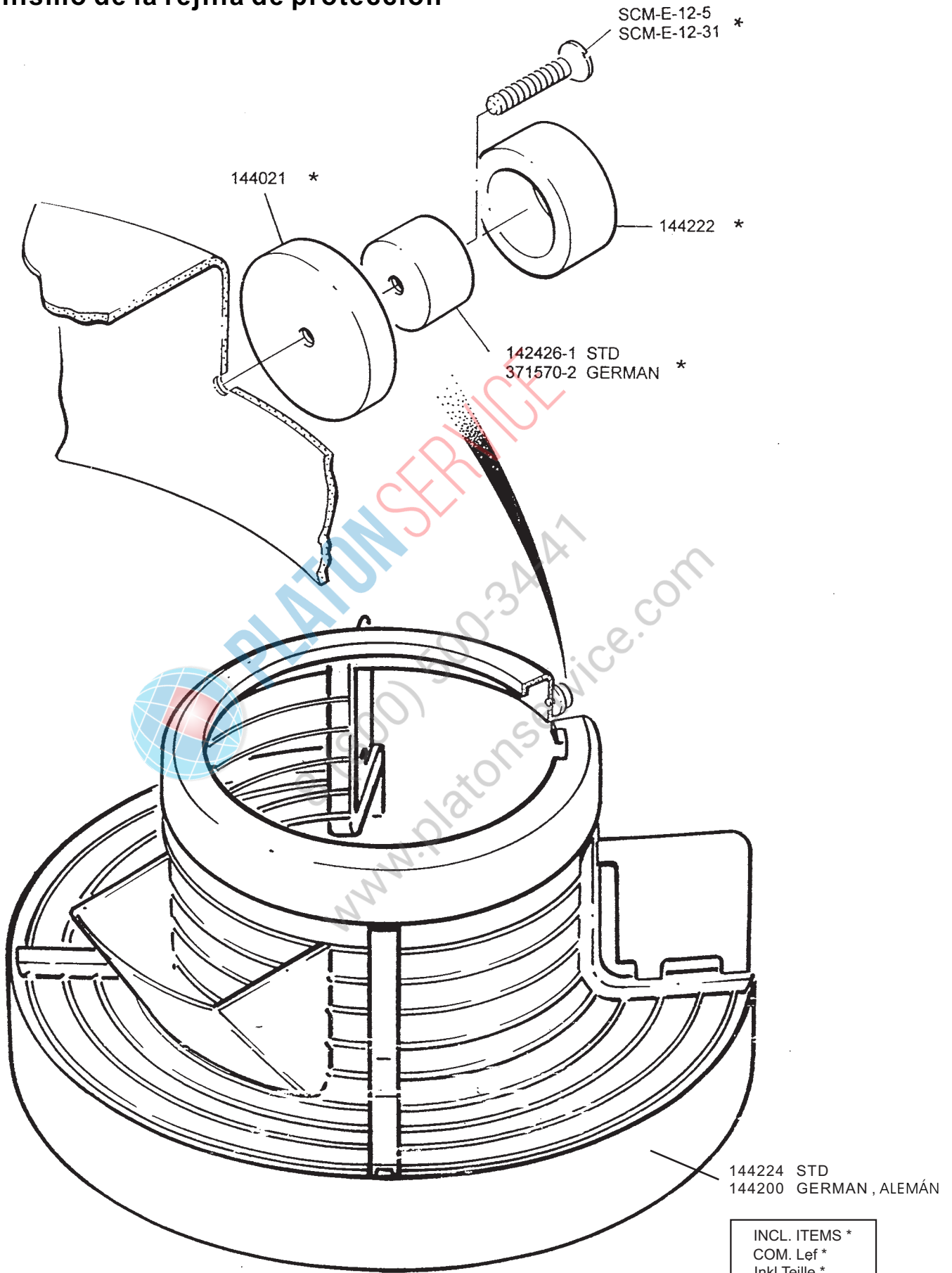

## Guard Interlock Assembly Verrouillage de sécurité de bol Sicherheitsschalter Mecanismo interbloqueo de la rejilla de protección

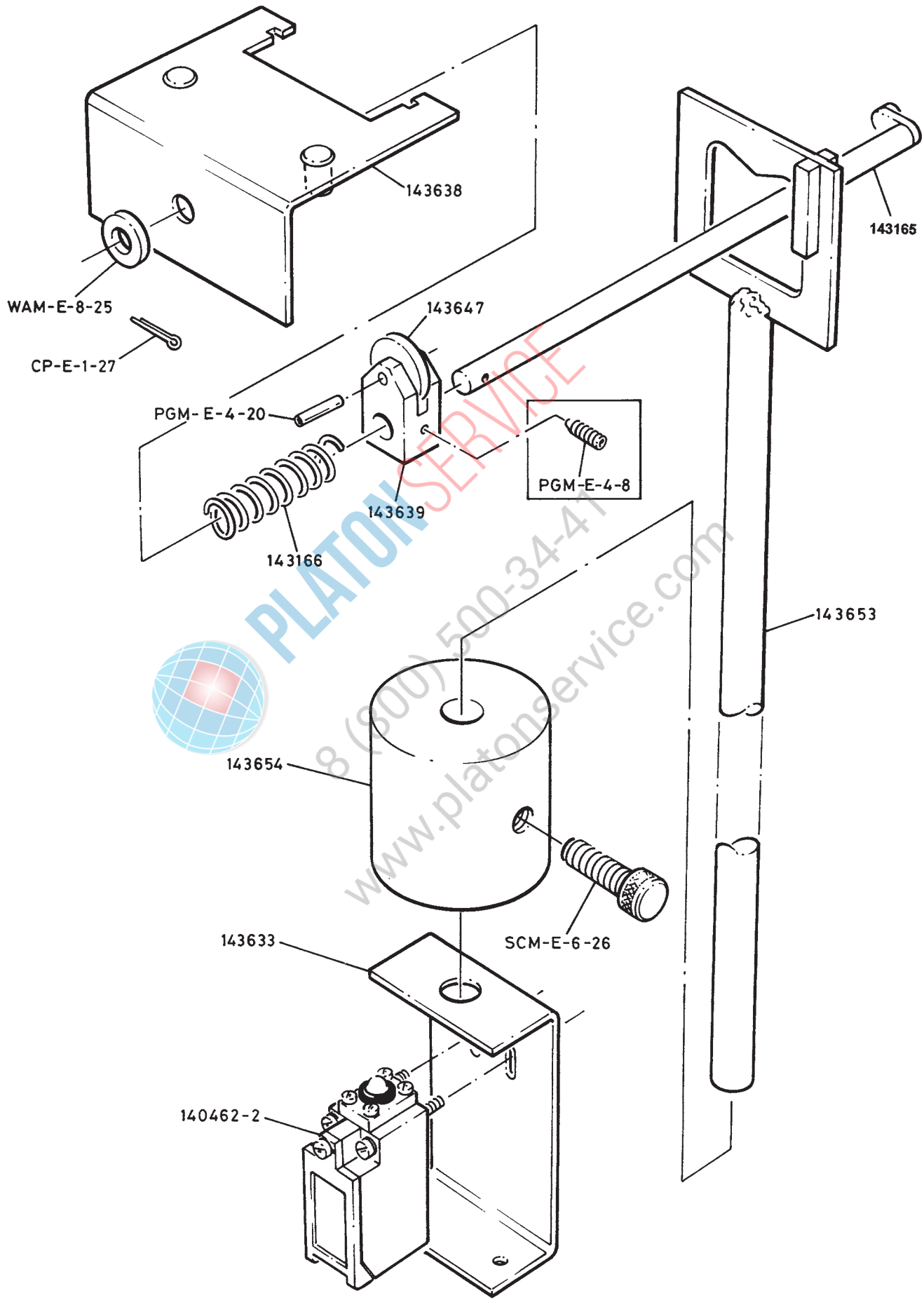



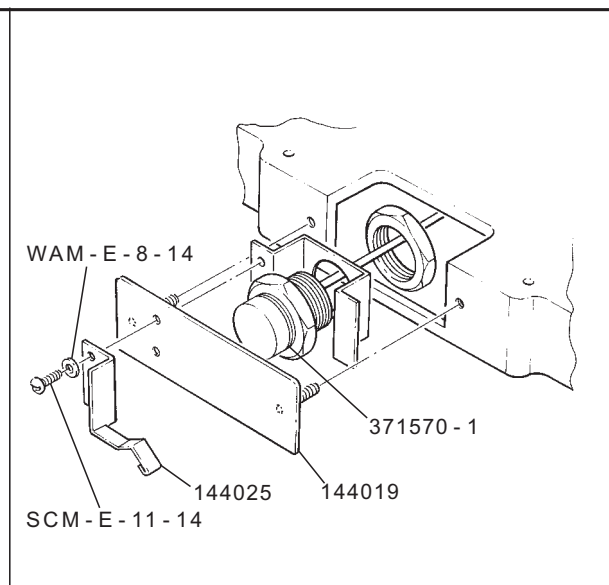
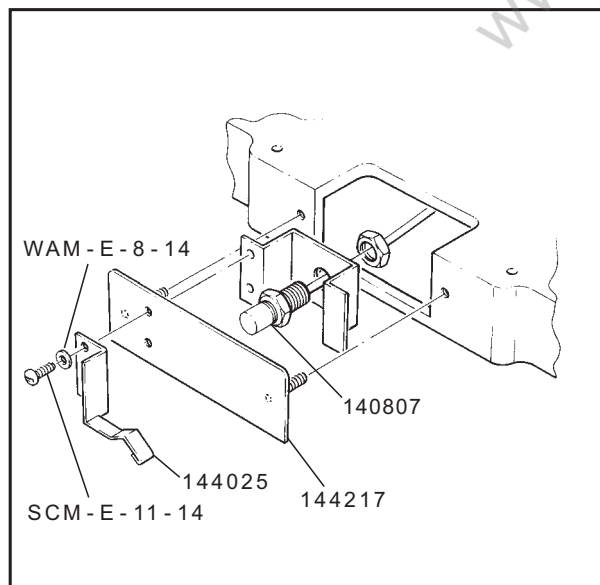
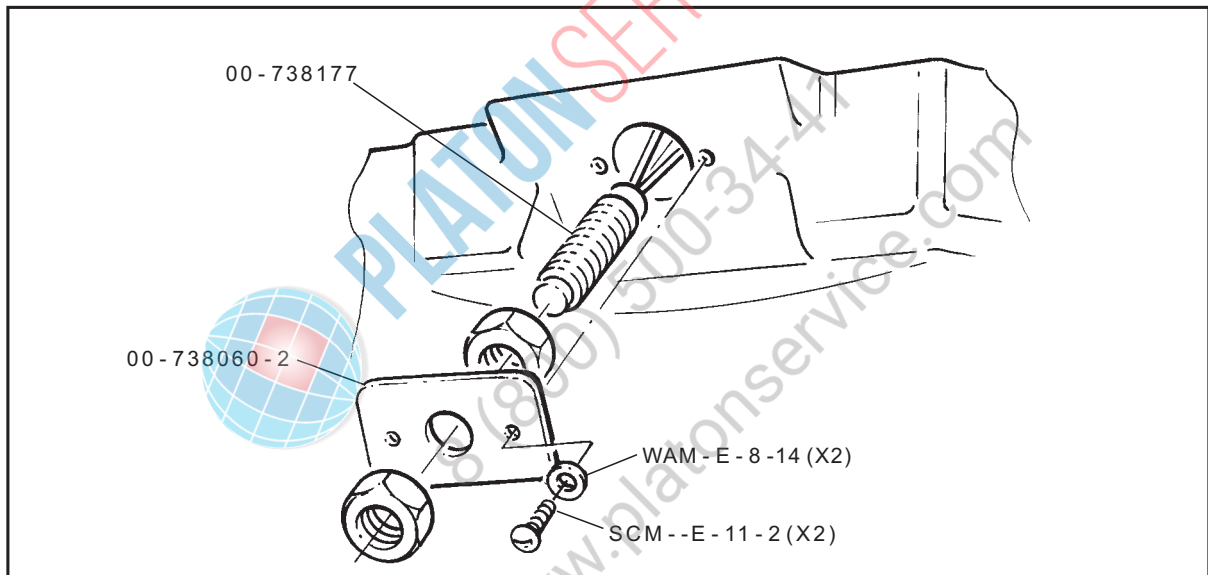
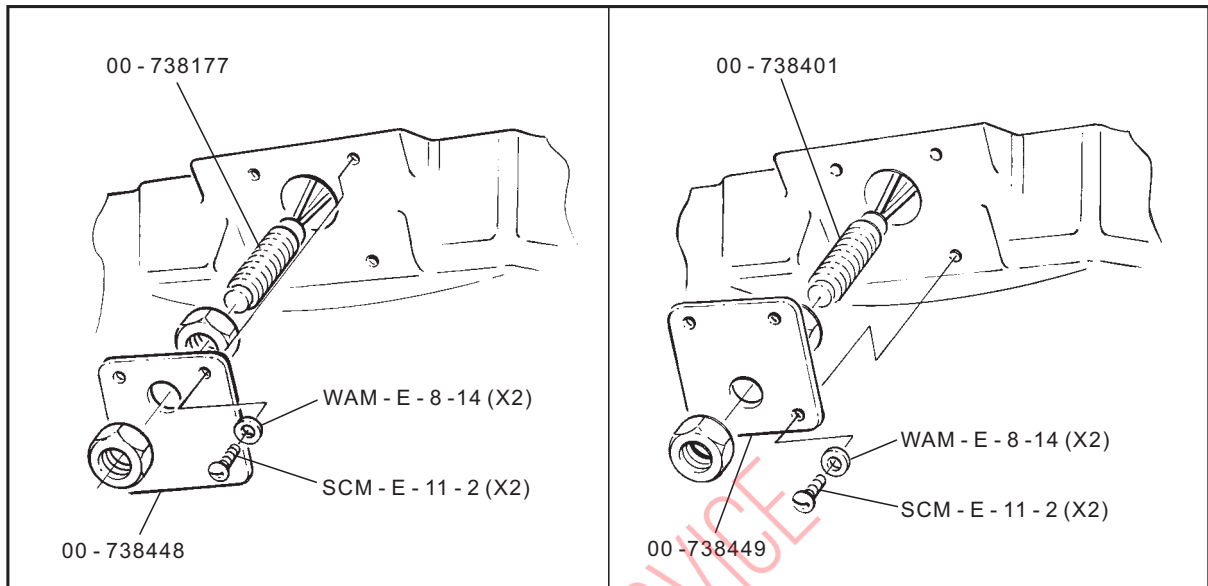

115v 60Hz 1 Ph	MM	X1
230v 50Hz 1 Ph	C/D	X1
230v 50Hz 3 Ph	F/G	X2
400v 50Hz 3 Ph	H/J	X3
400v 50Hz 3 Ph + N	K/L	X1
440v 60Hz 3 Ph	QQ	X3

139272-11	MM	115v 60Hz 1 Ph
142403-8	C/D	230v 50Hz 1 Ph
142403-7	F/G	230v 50Hz 3 Ph
142403-7	H/J	400v 50Hz 3 Ph
142403-7	K/L	400v 50Hz 3 Ph + N
142403-7	QQ	440v 60Hz 3 Ph

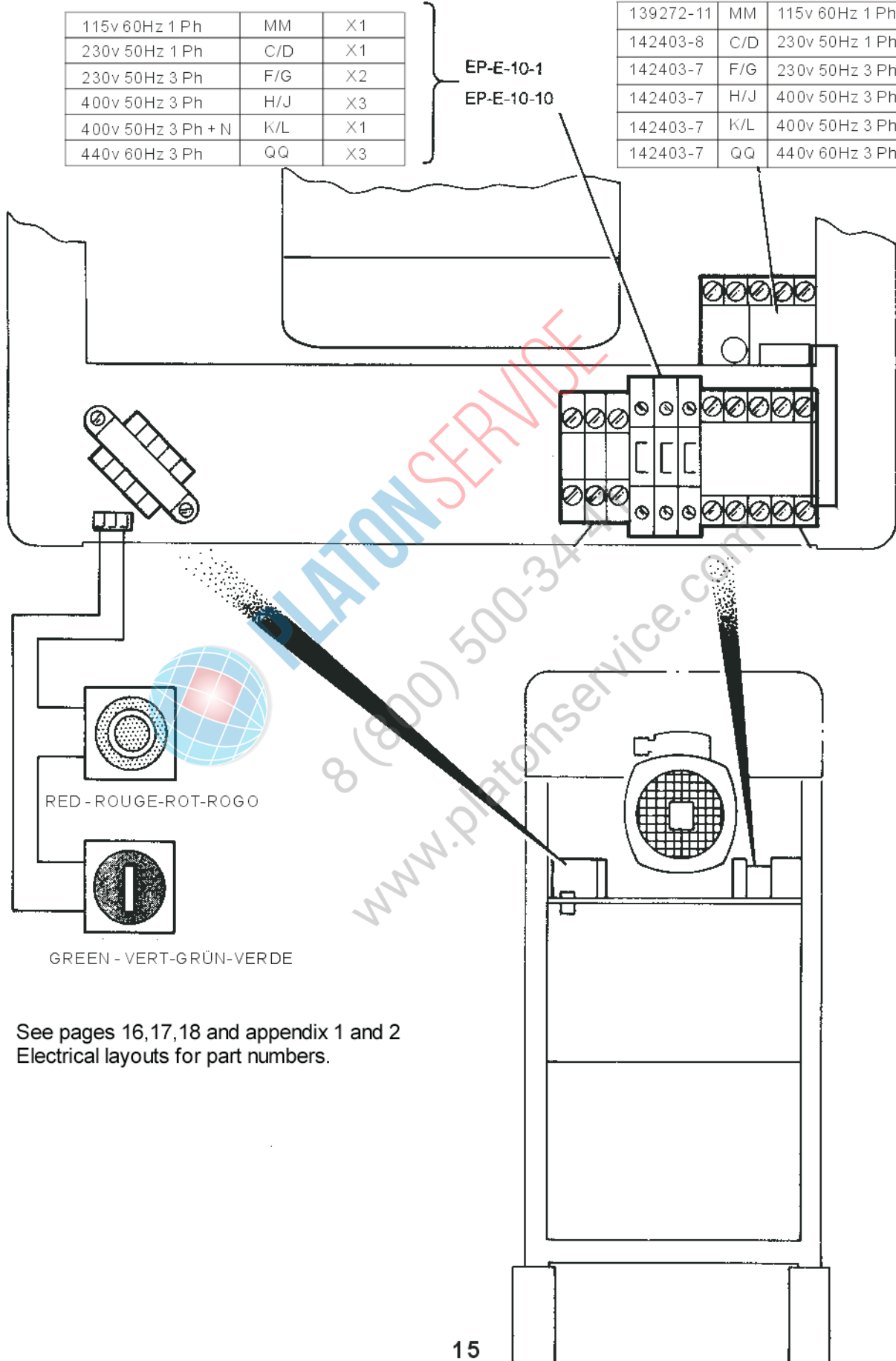

See pages 16,17,18 and appendix 1 and 2  
Electrical layouts for part numbers.

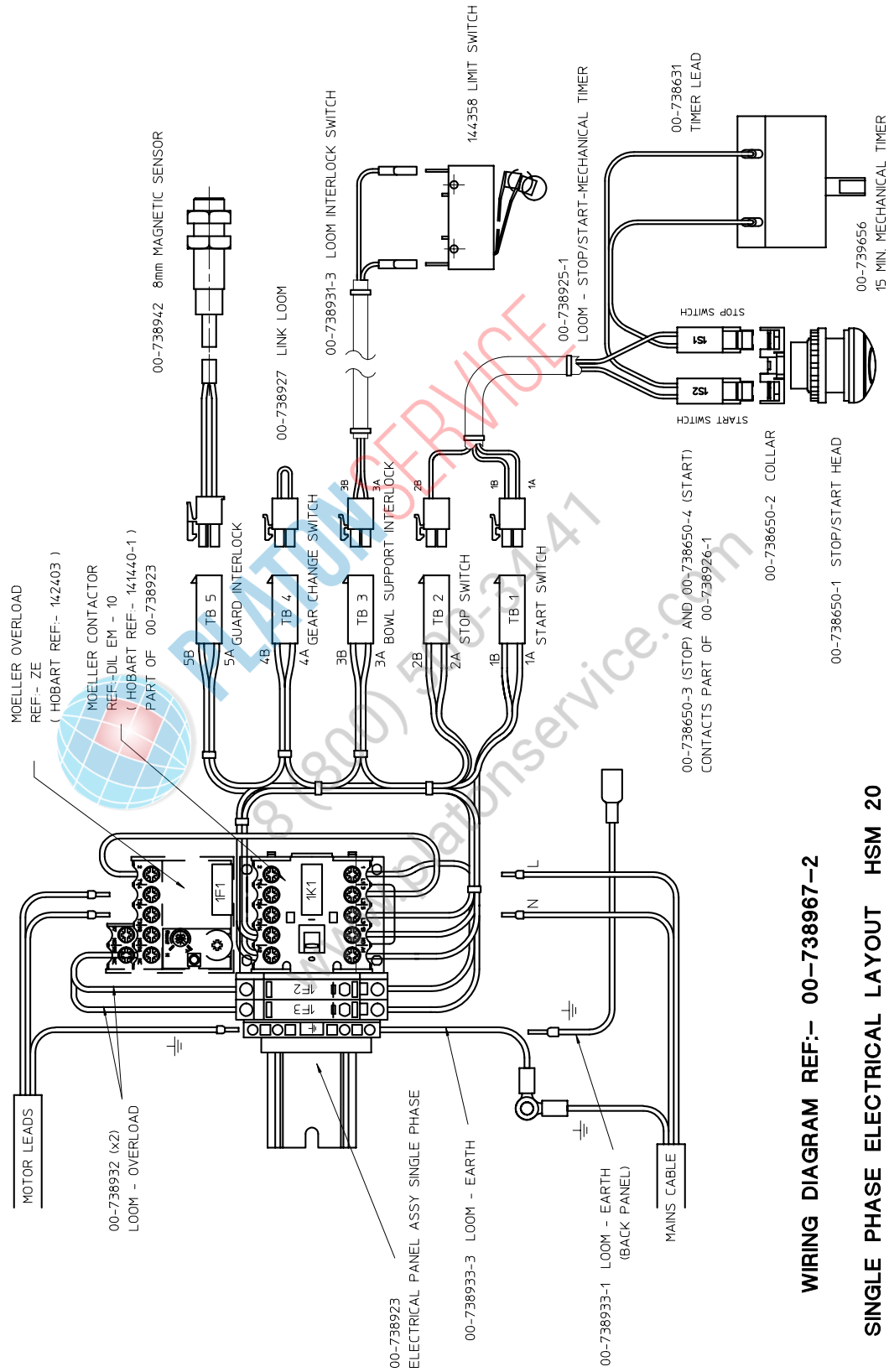

WIRING DIAGRAM REF:- 00-738967-2

SINGLE PHASE ELECTRICAL LAYOUT HSM 20

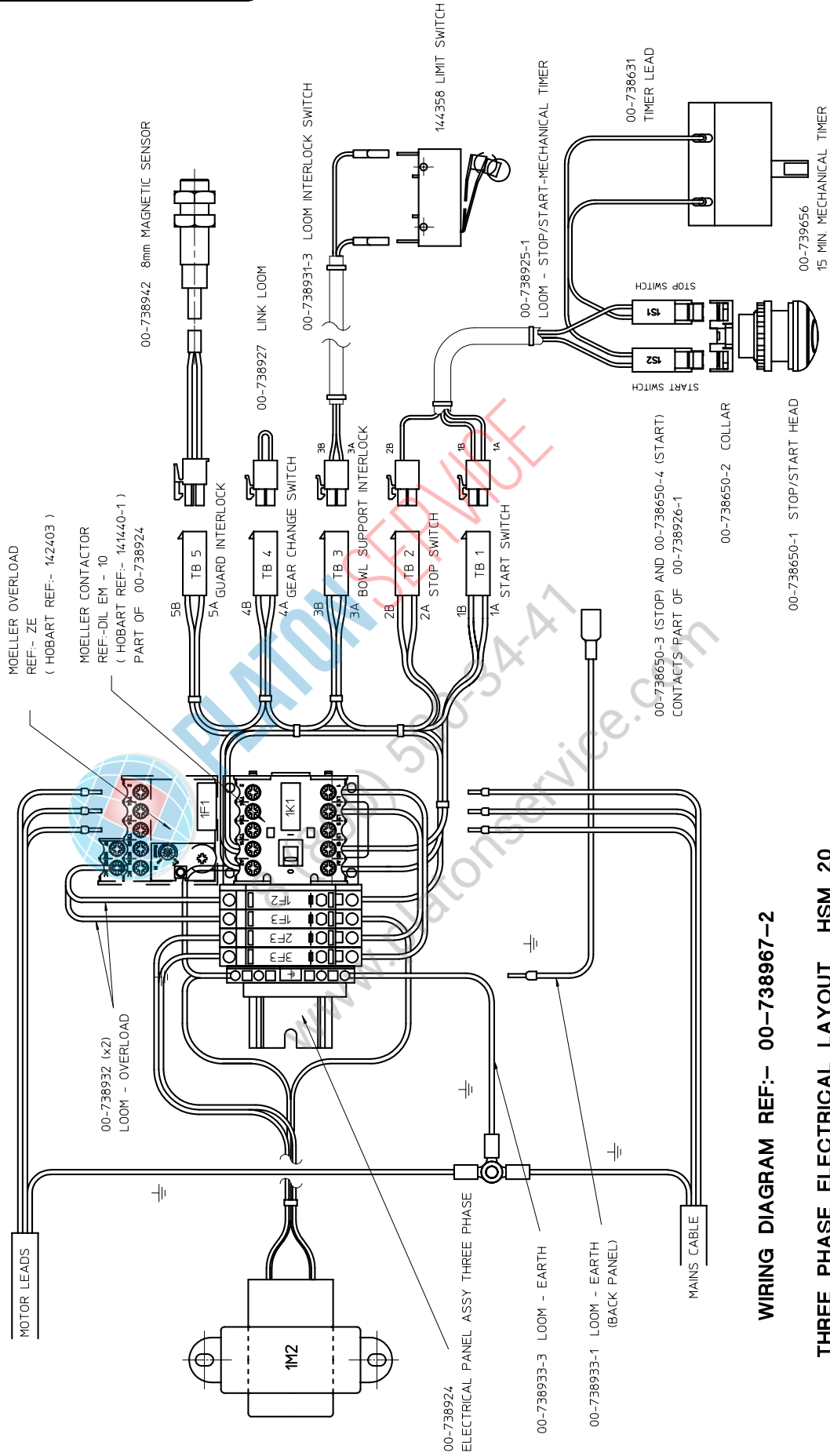

WIRING DIAGRAM REF:- 00-738967-2

THREE PHASE ELECTRICAL LAYOUT HSM 20

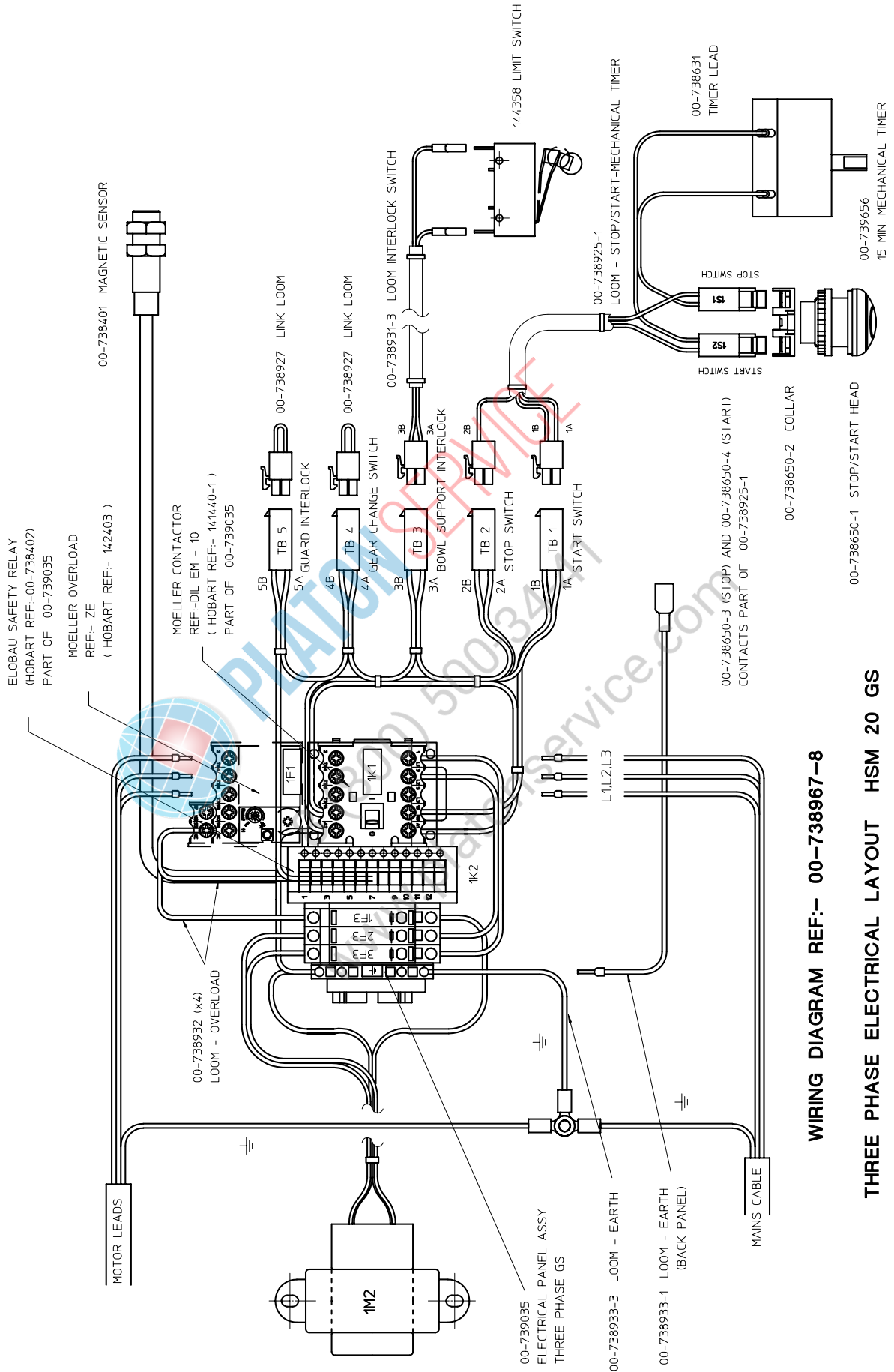

WIRING DIAGRAM REF:- 00-738967-8

THREE PHASE ELECTRICAL LAYOUT HSM 20 GS

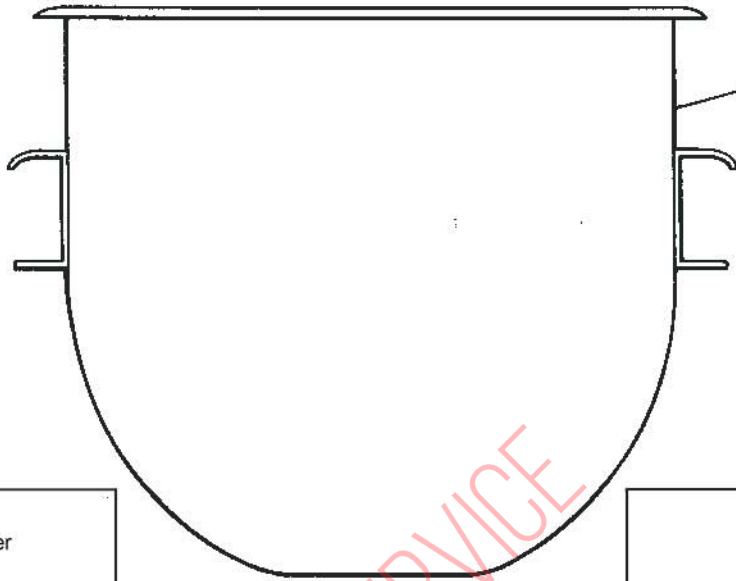

62104 20qt  
00-738450 10qt

23126	20Lt "B" Beater
136915	10Lt "B" Beater
275559	20Lt "B" Beater ST.ST
136915-1	10Lt "B" Beater ST.ST

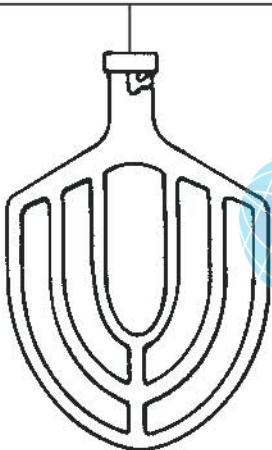

40293	20Lt "ED" Hook
-------	----------------



136912	10Lt "E" Hook
--------	---------------

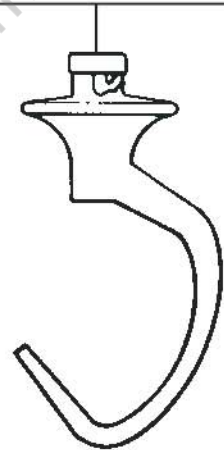

74286	20Lt "PK" Pastry knife
136914-2	10Lt "PK" Pastry knife ST.ST

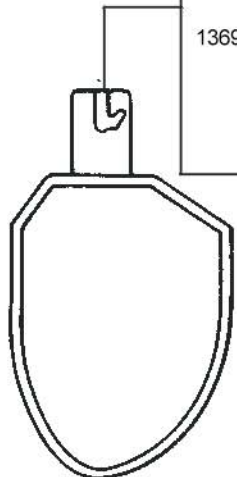

23511-M	20D Whip
140249	10D Whip

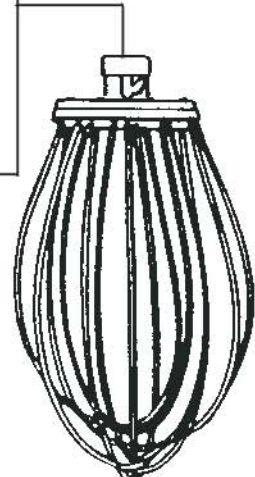

PLATON SERVICE  
8 (800) 500-34-47  
www.platonservice.com



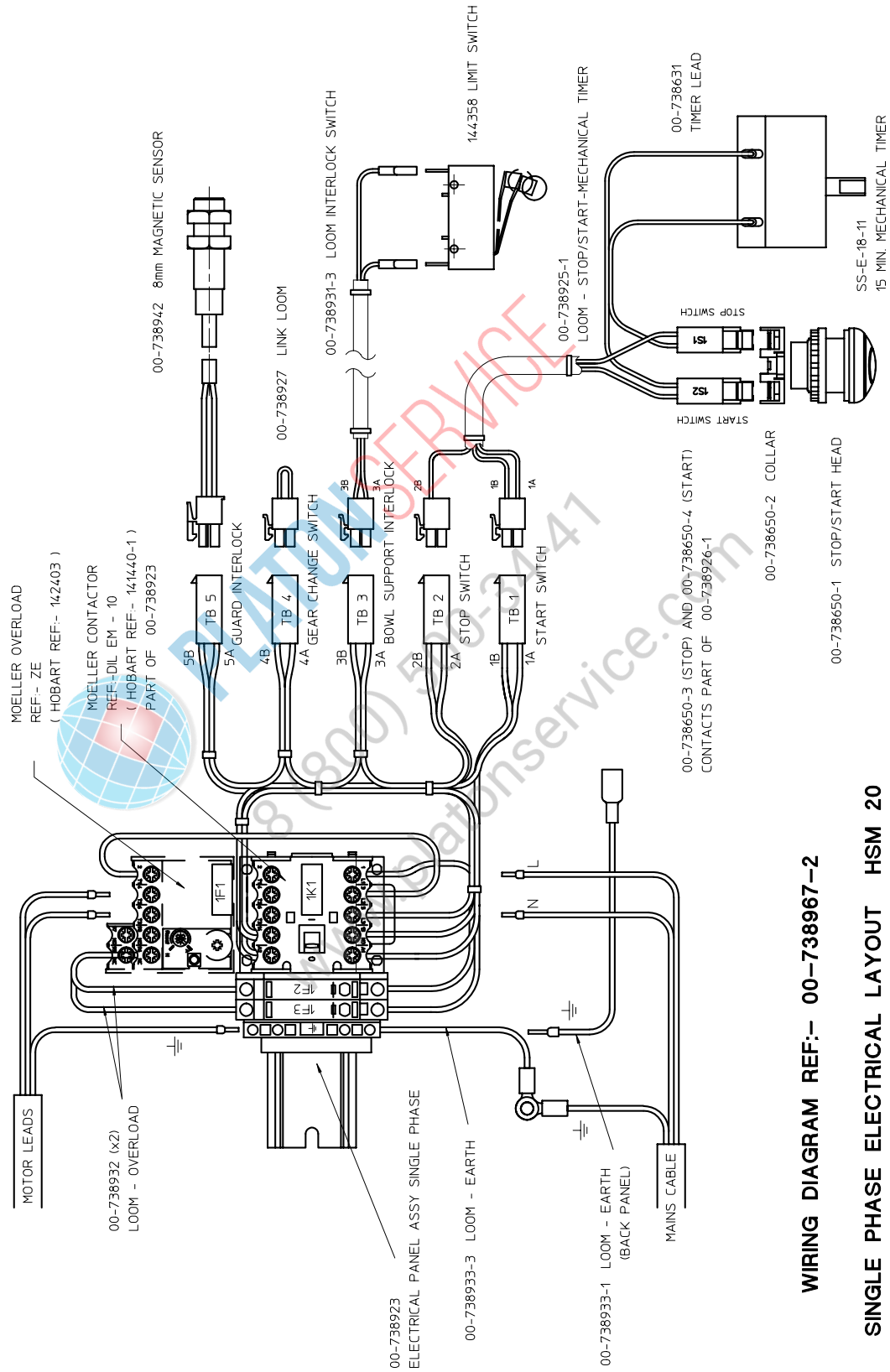

WIRING DIAGRAM REF:- 00-738967-2

SINGLE PHASE ELECTRICAL LAYOUT HSM 20

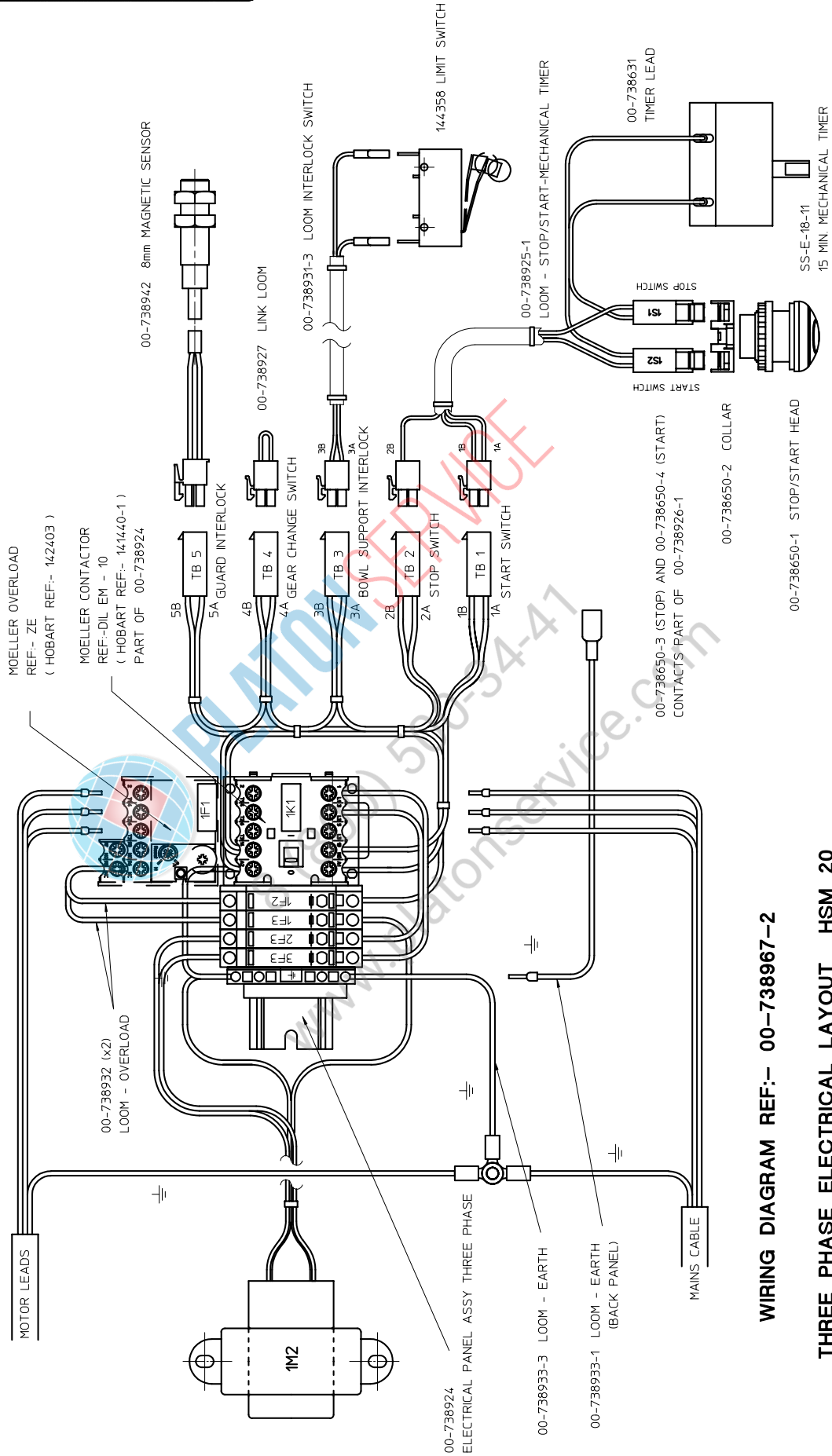

WIRING DIAGRAM REF:- 00-738967-2

THREE PHASE ELECTRICAL LAYOUT HSM 20

# **HOBART**

Hobart trained service technicians strategically located at the listed Hobart branches are prepared to give you fast, efficient and reliable service. Protect your investment by having a Hobart inspection contract, which assures the continued, efficient operation of your Hobart machines, spares and accessories.

**For further details contact:-**

## **HOBART SERVICE UK**

**0844 888 7777**

**Hobart UK  
Hobart House, 51 The Bourne,  
Southgate, London N14 6RT  
Tel: 020 8920 2800 Fax 020 8886 0450  
www.hobartuk.com**

Continued product improvement is a Hobart Still policy, specifications may change without notice.



## **HOBART SERVICE GERMANY**

### **SERVICE-INFORMATIONEN UND -TELEFONNUMMERN.**

**Ausführliche Informationen erhalten Sie bei Ihrem Fachhändler, oder unter:**

**Service Tel. 01803 / 45 62 58 – [www.hobart.de](http://www.hobart.de) – [info@hobart.de](mailto:info@hobart.de) (innerhalb Deutschland)**

**HOBART behält sich das Recht vor, an allen Produkten Änderungen oder Verbesserungen ohne Ankündigungen vorzunehmen**

## **HOBART SERVICE FRANCE**

**Telephone : 0825021222**

**Hobart ayant une politique d'amélioration constante de ses produits, les spécifications peuvent changer sans préavis.**